

DePrizio-Jorgano Construction Inc.

248 Everett Avenue, Chelsea, Massachusetts 02150 • Tel. (617) 884-1802 • Fax (617) 884-2506

April 27th 2017

Town of Winthrop
Town Hall
One Metcalf Square
Winthrop, MA. 02152
Attn: Mr. Russ Sanford & Joseph J. Domelowicz Jr.

Re: Winthrop Middle School

Russ/Joe,

As you requested I am submitting the following proposal in reference to the above project.

Price Includes:

1. R&D of School, Auditorium & Gymnasium completely.
2. R&D of footing & foundations.
3. Dust control
4. Grade site upon leaving.
5. One mobilization.

Price Excludes:

1. Salvage of items.
2. Details. (Police/fire)
3. Shoring & bracing.
4. Sediment & erosion control.
5. Permits & fees.
6. Site fencing/Pest control
7. Hazardous material.
8. Site work/excavation.
9. Any & all testing.
10. Make safe. (Cut & cap all utilities @ street)

Price for the above scope of work: \$757,500.00

SEVEN HUNDRED FIFTY SEVEN THOUSAND FIVE HUNDRED DOLLARS

- Complete take down of School & Auditorium only - \$612,400.00
- Complete take down of School only - \$525,100.00
- Complete takedown of Auditorium only - \$178,200.00
- Complete takedown of Gym only - \$177,900.00
- Crush entire 3 buildings to 4" minus and leave on site-Savings to owner \$120,000

I hope this is acceptable if you have any questions please don't hesitate to call.

Thank you,

David DePrizio

This Proposal will expire in 60 days





Winthrop, MA

1 inch = 67 Feet



March 21, 2017

www.cai-tech.com

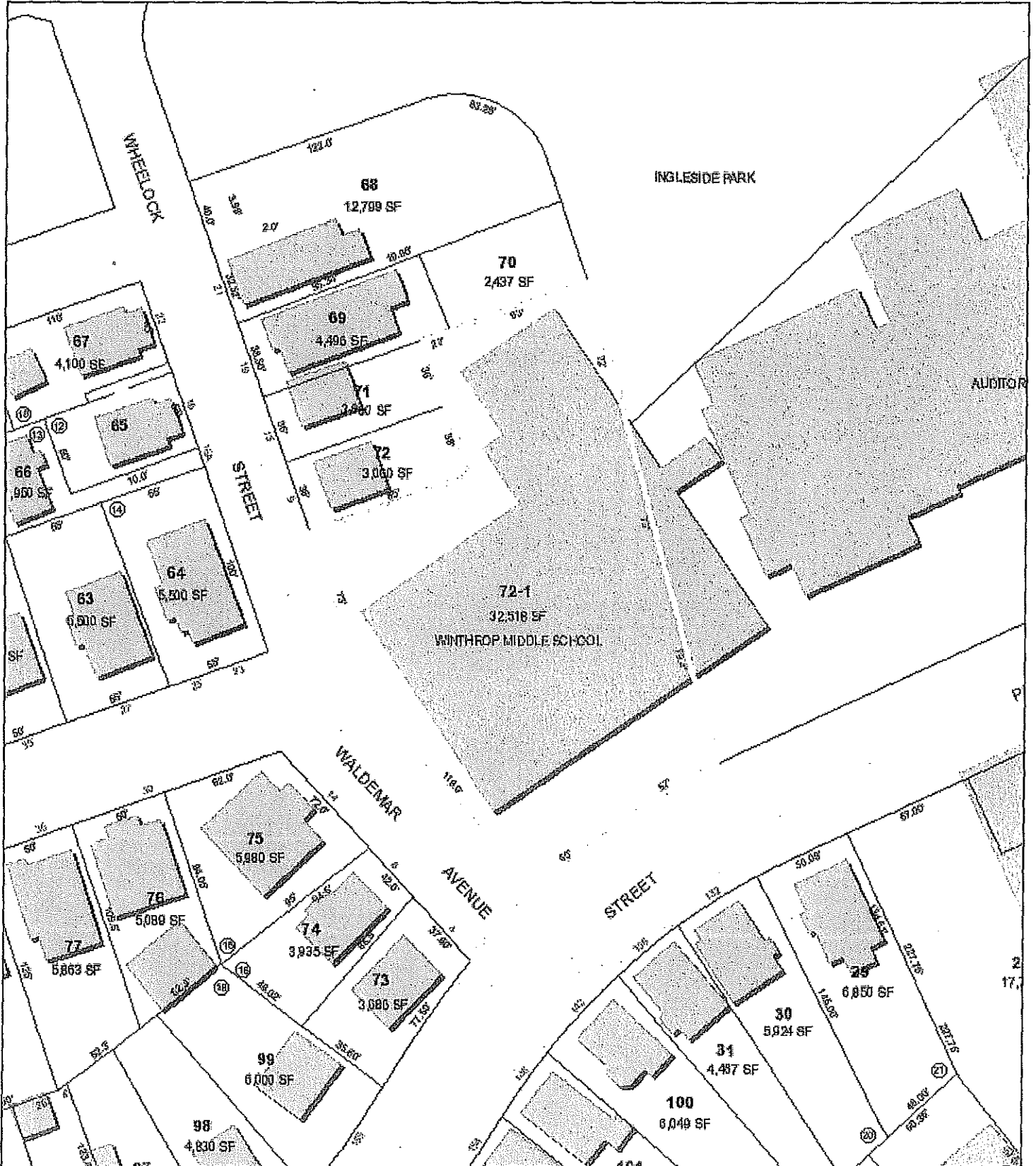

Data shown on this map is provided for planning and informational purposes only. The municipality and CAI Technologies are not responsible for any use for other purposes or misuse or misrepresentation of this map.

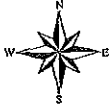

Winthrop, MA

1 inch = 67 Feet

March 21, 2017

www.cai-tech.com

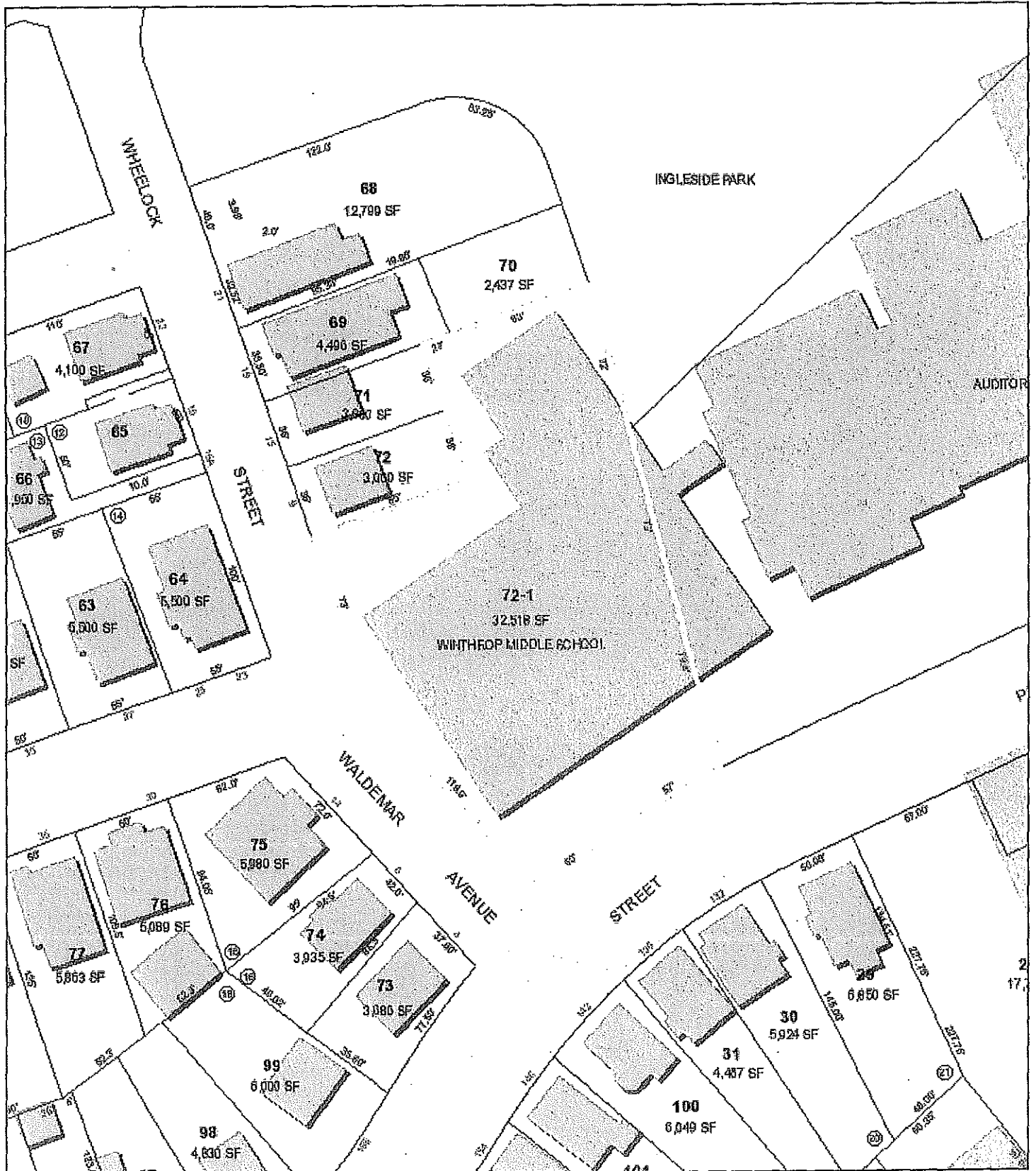

Data shown on this map is provided for planning and informational purposes only. The municipality and CAI Technologies are not responsible for any use for other purposes or misuse or misrepresentation of this map.